



## MEMBRÁNOVÉ ELEKTRICKÉ ČERPADLÁ

Séria Duplex II

D3131B1311AR

Membránové elektrické čerpadlá

- Prietok až 7,6 l/min
- Tlak až 6,9 Bar



### POPIS PRODUKTU

## ŠPECIFIKÁCIA

<b>Bypass</b>	Áno
<b>Flow</b>	6,1 l/min
<b>Hmotnosť</b>	2 kg
<b>Materiál membrány</b>	Buna
<b>Material of valves</b>	Buna
<b>Materiál tela</b>	Polypropylén
<b>Max. dovolený tlak</b>	3,4 bar
<b>Napätie</b>	12 V
<b>Power consumption</b>	7 A
<b>Prevádzková teplota max.</b>	60 °C
<b>Procesné pripojenie</b>	3/8 NPT
<b>Self-sufficiency max</b>	2,4 m

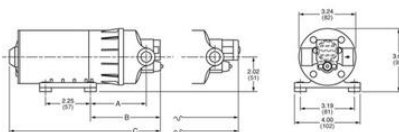

DEMAND PUMP	A	B	C
Minimum Dimension	2.53 (64)	3.98 (101)	8.00 (203)
Maximum Dimension	2.79 (71)	4.79 (122)	8.61 (219)
BY PASS PUMP			
Minimum Dimension	2.53 (64)	3.25 (83)	7.27 (185)
Maximum Dimension	2.79 (71)	3.51 (89)	7.73 (196)

CURVE 4

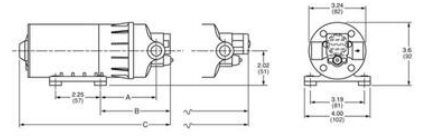
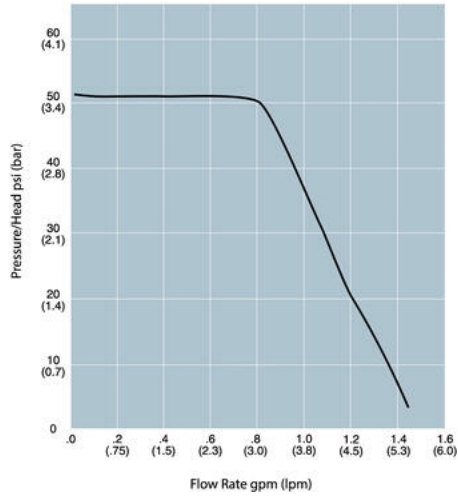

DEMAND PUMP	A	B	C
Minimum Dimension	2.53 (64)	3.98 (101)	8.00 (203)
Maximum Dimension	2.79 (71)	4.79 (122)	8.61 (219)
BY PASS PUMP			
Minimum Dimension	2.53 (64)	3.25 (83)	7.27 (185)
Maximum Dimension	2.79 (71)	3.51 (89)	7.73 (196)