



ROZDELENÝ DVOJNIPL

Séria ADAPTERS

2060 1/8

Rozdelený dvojnipl G1/8

- Teplota -20°C do 80°C
- Tlak max. 50 bar
- Telo z mosadze



POPIS PRODUKTU

ŠPECIFIKÁCIA

| | |
|--------------------------|--------------------|
| Balenie | 10 ks |
| Materiál tela | Poniklovaná mosadz |
| Prevádzková teplota max. | 80 °C |
| Prevádzková teplota min. | -20 °C |
| Procesné pripojenie | G1/8 |
| Tlakový rozsah max. | 150 bar |
| Tlakový rozsah min. | -0,99 bar |
| Tvar tela | I |



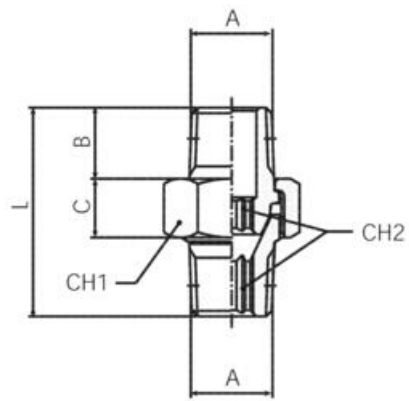

| | A | B | C | L | CH1 | CH2 |
|----------|-----|------|------|------|-----|-----|
| 2060 1/8 | 1/8 | 9,0 | 8,5 | 27,0 | 15 | 5 |
| 2060 1/4 | 1/4 | 11,5 | 9,5 | 33,5 | 19 | 6 |
| 2060 3/8 | 3/8 | 13,0 | 10,0 | 36,5 | 22 | 8 |
| 2060 1/2 | 1/2 | 15,5 | 12,0 | 45,0 | 27 | 12 |
| 2060 3/4 | 3/4 | 18,0 | 17,0 | 52,5 | 36 | 14 |
| 2060 1 | 1 | 22,0 | 20,0 | 63,5 | 46 | 19 |